

DIMAC Boring Fixture

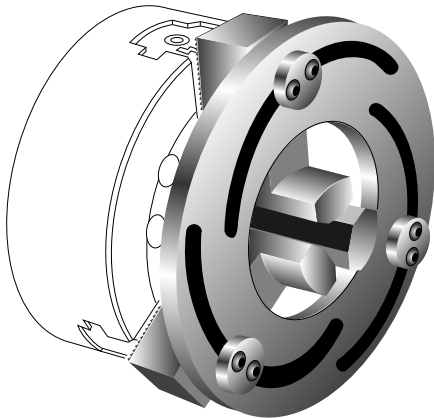

Dimac Boring Fixtures eliminate the need to use a disc or bung when boring jaws.

- Fixture for accurate and reliable machining of Soft Jaws
- Reduces set-up time
- Attaches quickly, no need for tools
- Compensates for "Jaw Lift"
- Applies equal pressure to all jaws
- Now possible to "Through Bore" jaws since no disc or bung is used.



Part No.	Chuck Size	
BF05	5"	125mm
BF06	6"	150mm
BF08	8"	200mm
BF10	10"	250mm
BF12	12"	300mm
BF15	15"	380mm

How to use the Boring Fixture

Simply reduce the chuck pressure, place the Boring Fixture against the chuck, aligning the Boring Fixture pegs with the holes in the Soft Jaws. Activate the chuck, ensuring that the jaw stroke does not bottom out, and start boring the jaws as required. When complete, unclamp the chuck and remove the Boring Fixture.

DIMAC Chuck Grease

Chuck Maintenance & Repair

DIMAC Chuck Grease
as recommended by KITAGAWA.

DIMAC offers a comprehensive chuck maintenance and repair service for most makes and models of power chucks. For a minimum fee we will dis-assemble, inspect and evaluate your chuck on site or at our premises.

Our experienced service department can then repair your chuck using the highest quality spares and equipment. This includes greasing your chuck with recommended Chuck Grease.



Part No.	Description	Notes
CGDC450	450g Cartridge	Ref. Picture
CGDC1	1 kg Tin	Ref. Picture
CGDC16	16 kg Pail	Suitable for pressure greasing
GGMN450	Grease Gun	Modified nozzle. Suits 450g cartridge.